

# HPS-SAH-WP Weather Proof Manual Pull Stations

## DESCRIPTION

The Hochiki HPS-SAH-WP Weatherproof Manual Pull Station is a UL Listed fire alarm initiating device suitable for applications requiring outdoor mounting of the manual fire alarm pull station. The HPS-SAH-WP is appropriate for applications where the manual pull station may be subject to wet conditions.

The HPS-SAH-WP consists of a die-cast aluminum back box (HPS-BB), Neoprene sealing gasket and a special manual fire alarm box. The unit is a high quality pull station constructed entirely of nontoxic materials with a low profile and rounded edges to fit most design requirements. All components are pre-painted, or have plated surfaces to inhibit corrosion.

The latching pull-down lever on the HPS-SAH-WP requires a hex key to reset it. This allows only authorized personnel to reset the manual pull station so that the origin of the alarm can be determined easily.

The HPS-SAH-WP has one set of Normally Open contacts rated for 10A @ 120 VAC, making the device suitable for installations involving large current loads.

The HPS-SAH-WP conforms with the Americans with Disabilities Act (ADA).



## STANDARD FEATURES

- Weatherproof Manual Pull Station
- 10 A, 120 VAC contacts
- Rugged die-cast aluminum housing
- Neoprene sealing gasket
- Corrosion-resistant construction
- Hex reset
- Latching pull-down lever
- Screw terminal connections

## SPECIFICATIONS

Model	HPS-SAH-WP
Contact	(1) Form A
Contact Rating	10A @ 120 VAC
Operating Temperature	-30°F (-35 °C) ~ 150°F (66°C)
HPS-BB Dimension	1-3/4" Backbox

## PRODUCT LISTINGS

SIGNALING



S6512



California State Fire Marshal

7150-0410:162

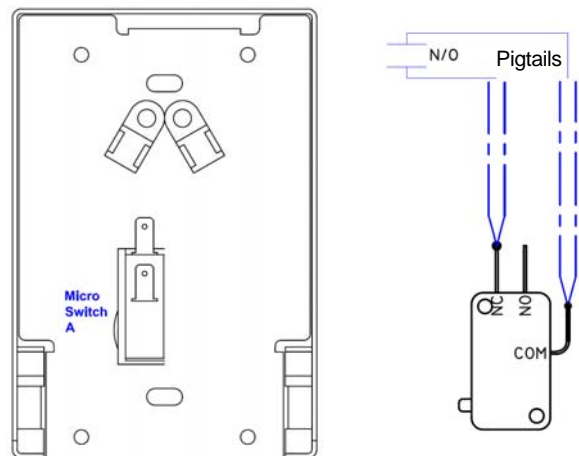

Specifications subject to change without notice

## Hochiki America Corporation

7051 Village Drive, Suite 100 Buena Park, CA 90621-2268  
 Phone: 714/522-2246 Fax: 714/522-2268  
 Technical Support: 800/845-6692 or technicalsupport@hochiki.com

Find latest revision at [www.hochiki.com](http://www.hochiki.com)



F0035

02/2014