

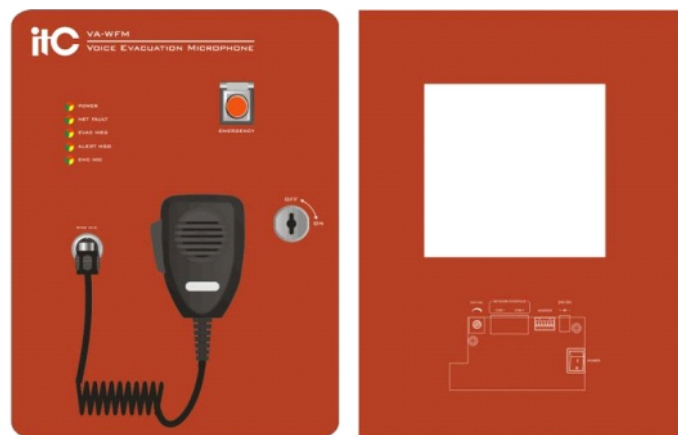

# Voice Evacuation Microphone

## VA-WFM



### Descriptions:

- \*Paging to all zones in the system.
- \*Enter into or exit the emergency mode.
- \*Support fireman mic recording function.
- \*Support self detection in paging conflict status.
- \*Can display the EVAC/ALERT audio source status.
- \*Same priority of fireman mic and PTT mic.
- \*Support power supplied by 24V DC and network cable.
- \*Support max 4pcs fireman mics.

### Specifications:

Model	VA-WFM
Power supply	Voltage ~ DC 24V battery
Mic input	24V network port
Sensitivity	5MV±0.5mV
Frequency response	200Hz~10kHz
Input impedance	≥1kΩ
CAN interface	CAN interface of remote mic Baud rate of 100bps Support up to 4 fireman mic
Dimension(mm)	260×200×100mm
Net weight	2.3Kg
Installation	Wall mounted
Color	Grey
Operating temperature	+5°C ~ +40°C
Storage temperature	-20°C ~ +70°C
Relative temperature	<95%